

DRX2; 2-Circuit Track LED 7° Optic 36W

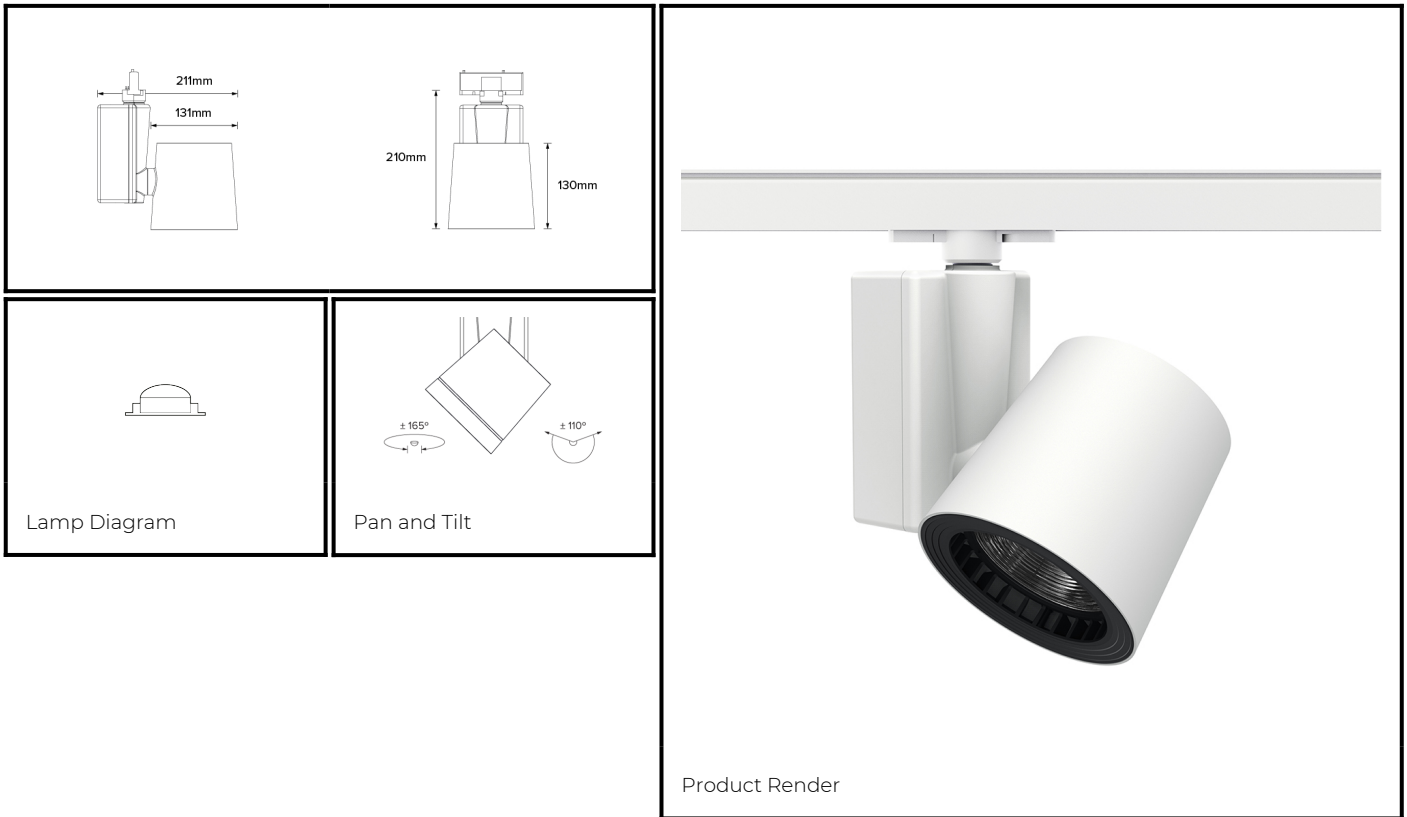

PHYSICAL	CONSTRUCTION MATERIALS:	A380 Aluminium, Glass-filled Polycarbonate
	MOUNTING:	2-Circuit Track
	WEIGHT:	1.9 kg
	FINISH:	White RAL9010
	MAX AMBIENT TEMPERATURE:	40°C
	CEILING CLEARANCE:	N/A
	CEILING CUT-OUT:	N/A
	CEILING THICKNESS:	N/A

CONTROL	MOVEMENT TYPE:	RCL Control
	DIMMING OPTION:	RCL Control

SPECIFICATION DRX2 2700K LED (25W for light source) compact spotlight for 2-Circuit Eutrac with 7° optic. Manufactured from A380 aluminium and glass-filled polycarbonate. Finished in white (RAL 9010). Voltage is 100-240V 50/60HZ. Luminaire has high-performance colour rendering of 90+ CRI. Luminaire can be rotated, with +/- 165° movement through the pan axis and +/- 110° through the tilt axis, at a resolution of less than 1° in either axis. Movement and dimming is controlled using RCL Control iOS App. Recording and recalling of scenes as standard.

PART NO.

DRX2.0042

PRODUCT SUMMARY

DRX2 Spotlight; 100-240V 50/60Hz; 2~ Eutrac; 7° Optic; 2700K 90+CRI COB LED 25W; White; Movement & Dimming using RCL Control

DRX2; 2-Circuit Track LED 7° Optic 36W

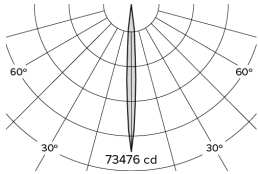

Photometry



Cone Diagram

MOVEMENT	MOVEMENT TYPE:	RCL Control
	PAN MOVEMENT RANGE:	±165°
	TILT MOVEMENT RANGE:	±110°
	PAN MOVEMENT RESOLUTION:	<1°
	TILT MOVEMENT RESOLUTION:	<1°
	PAN SPEED OF MOVEMENT:	24°/s
	TILT SPEED OF MOVEMENT:	22°/s

LIGHTING	LIGHT SOURCE:	LED
	MIN. DISTANCE FROM TARGET:	N/A
	MODULE LUMEN OUTPUT:	2200LM
	ABSOLUTE LUMEN OUTPUT:	1814LM
	GLARE MECHANICAL CUT-OFF:	11°
	GLARE COMFORT CUT-OFF:	53°
	COLOUR TEMP:	2700K

ELECTRICAL	VOLTAGE REGION:	100-240V 50/60Hz
	IEC PROTECTION CLASS:	Class 1
	LIGHT SOURCE WATTAGE:	25W
	MOVEMENT WATTAGE:	5W
	LUMINAIRE CIRCUIT WATTAGE:	36W

PART NO.

DRX2.0042

PRODUCT SUMMARY

DRX2 Spotlight; 100-240V 50/60Hz; 2~ Eutrac; 7° Optic; 2700K 90+CRI COB LED 25W; White; Movement & Dimming using RCL Control