

Installation Instructions

RCL Control Application

⚠ BEFORE YOU START

Read these instructions carefully. For the latest instructions on all our products see www.rclighting.com/downloads

⚙ These instructions cover the following installation methods:

- A Inventory
- B System Requirements
- C RCL Mediator Installation
- D Wiring Instructions

⚙ If you have any difficulty installing this product please contact:

Remote Controlled Lighting Ltd (UK)
42 Riverside Road, London SW17 0BA
+44 (0) 20 8404 2400
tech@rclighting.com

Remote Controlled Lighting Ltd (Asia)
Unit 13, 8/F, Lai Sun Yuen Long Centre
21-35 Wang Yip Street East,
Yuen Long, Hong Kong
T: +852 2310 9733
F: +852 2310 9723
asia_sales@rclighting.com

Copyright © 2017 Remote Controlled Lighting Ltd. All Rights Reserved.

⚠ Important Safety Information

READ INSTRUCTIONS CAREFULLY BEFORE USING THIS PRODUCT. SAVE INSTRUCTIONS FOR LATER REFERENCE.

⚙ Products must be installed by a suitably qualified professional only. Installations must conform to national installation codes and accident prevention regulations.

⚡ Ensure electrical rating shown on product label conforms to mains voltage supply.

⚡ Do not modify the product in any way. RCL accepts no responsibility for damage caused by modifying this product.

IP20 Product is rated IP20 unless otherwise stated. Install indoors only and away from damp or wet environments.

⚠ Caution, product will become hot in use. Allow to cool before touching.

♻ Dispose of this product in accordance with WEEE or other national regulations.

☐ Products marked with this symbol are compliant with Class 2 regulations.

A Inventory

- 1 Before you start, check that you have all the components listed below. The following items are provided by Remote Controlled Lighting and are included as part of the RCL Control package.

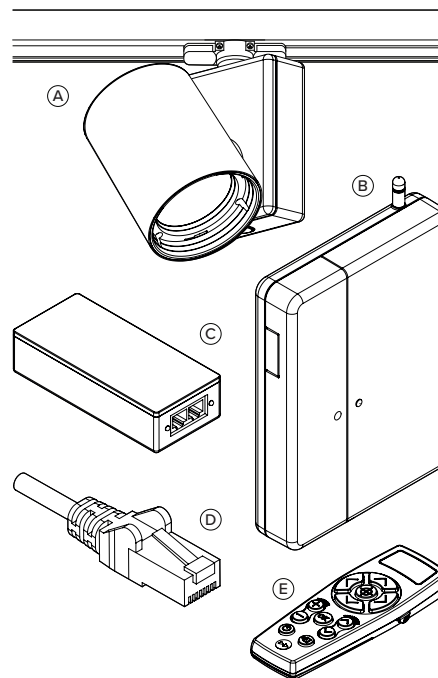

🔍 INVENTORY CHECK

- A RCL Luminaire (DRX1 shown as example)
- B RCL Mediator Box
- C PoE Injector
- D Network Cable
- E RCL Handheld Controller
- F Setup Instructions (DOC-291)
- G Mediator Mounting Guide (DOC-293)

- 2 the following items are not provided by RCL and are required to complete installation of RCL Control

🔍 ITEMS REQUIRED

- I WiFi Router
- J iPad (iOS 12 or later)

B System Requirements

For the RCL Control system to work efficiently, it is strongly advised that the installation process adheres to the following recommendations:

- 1 The RCL Mediator should be installed within **100 meters** of any given RCL Control enabled luminaire and *should not exceed* this distance.

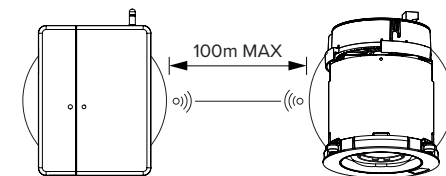

- 2 The *maximum distance* between individual RCL Control enabled luminaires should not exceed **25 meters**.

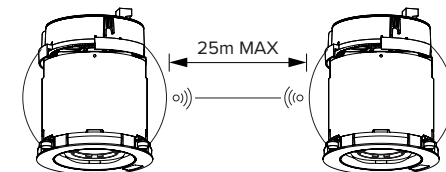

- 3 The mounting location of the RCL Mediator is important in order to optimise your system's performance. It is *strongly advised* that the RCL Mediator is mounted in sight of the RCL Control enabled luminaires.

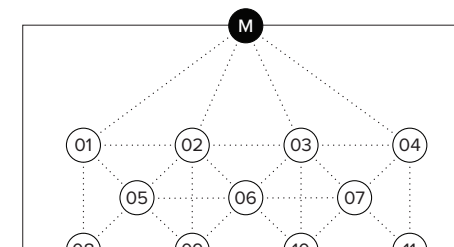

⚠ WARNING

- Do not locate the RCL Mediator behind masonry walls as signal strength will decrease. Only partition walls can be penetrated by the RCL Mediator signal.

C RCL Mediator Installation

- 1 To begin mounting the mediator, drill an M4 countersunk screw (or similar) in the centre of the desired mounting location.

Make sure to leave between 2-4mm of the screw head exposed to mount the Mediator Box on.

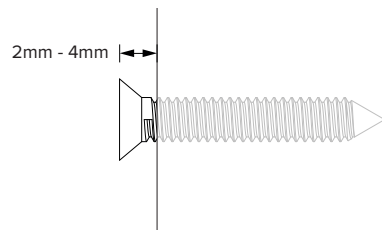

- 2 the RCL Mediator box is designed to conceal the internal cabling within a stud or partition wall. Follow the dimensions provided in DOC-293 to incorporate a concealed cable routing system.

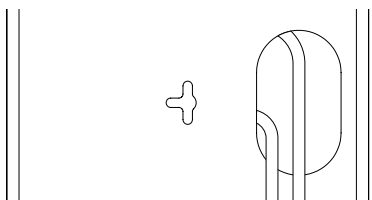

- 3 Locate the mounted screw with the vertical or horizontal mounting slot found on the back of the Mediator Box and engage the primary locking mechanism.

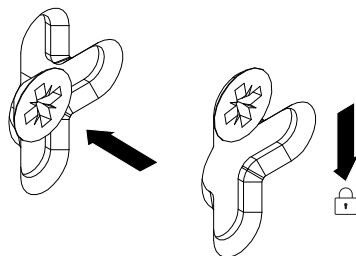

- 4 The Mediator Box will now need to be fastened to the wall or ceiling via 2x safety screws.

The RCL Mediator is capable of being securely mounted to a wall or ceiling with the use of 2 fastening holes, located in under the port hatch. Secure the RCL Mediator using suitable wood screws.

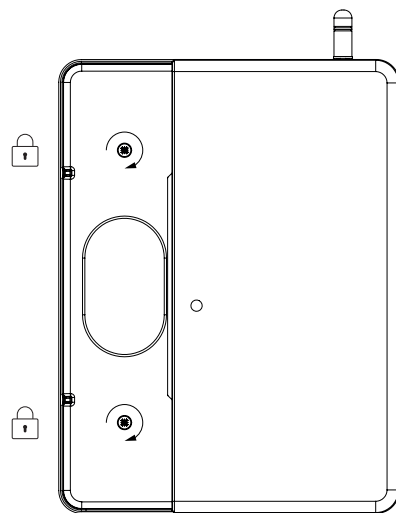

NOTE

- RCL Control is able to support a *maximum* of 200 luminaires per Mediator box. Exceeding this amount may result in a decrease in system performance. Excess of this amount would require an additional Mediator Box.

D Wiring Instructions

The RCL Mediator requires a DC Power connection and wired access to a WiFi router via a Power over Ethernet (PoE) Injector. Integration with external DALI systems is possible via the DALI interface.

- 1 Users are able to wire their RCL Control system discretely via the round slot located on the Mediator, or via the external knockout sections provided on the Mediator casing.

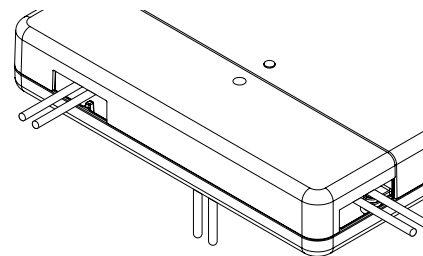

- 2 To connect the RCL Mediator to your network first make a connection between your WiFi router and the DATA/LAN port on the POE Injector using an Ethernet cable, then make a connection from the POE port on the injector to the RCL Mediator using a second Ethernet cable.

Finally, connect mains voltage to the Injector. The Injector can be up to 90m away from the Mediator.

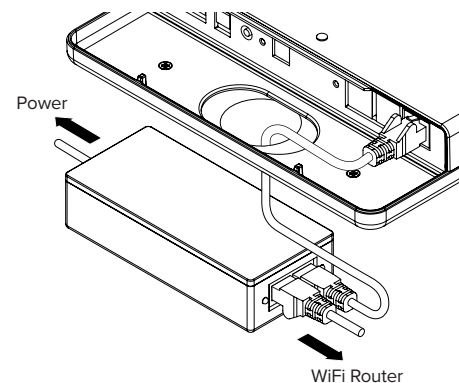

NOTE

- For an in-depth overview of RCL Control wiring, please refer to the wiring schematic shown in DOC-282-A

E Further Information

The steps within these installation instructions will enable the setup of a new RCL Control system.

- 1 For further information on how to use the app, please refer to the additional documents provided or within [DOC-291] RCL Control User Guide.
- 2 For specific training within the RCL Control app, tap on the help icon (?) in the top right corner of the user interface.

